



iS118-M Subwoofer



APPLICATIONS

Performing Arts Centers
Houses of Worship
Arenas/Auditoriums
Night Clubs
Cruise Ships
Entertainment Venues
A/V Systems Support

FEATURES

Max Output 133 dB SPL
10° Trapezoidal Arrayable Cabinet
LF Device: 18 in. (457.2 mm)
Integral Bimodal Rigging
Black Epoxy Mastic Finish
EP-4 Connector

GENERAL DESCRIPTION

The iS118-M is the mobile low frequency subwoofer extension of the Clair Brothers i-Series line array system designed for mobile applications. This arrayable subwoofer is specifically designed to complement the i208-M and i212-M mobile line array systems.

The 18 in. direct radiating transducer has a weather-resilient cone that produces exceptional linear excursion, and maximum peak to peak excursion of 70 mm (2.75 in). The result is a high power handling, high performance subwoofer that delivers tightly controlled low-frequency response.

The iS118-M has a three-point integral bimodal rigging system for various configurations. The cabinet may be flown above the i208-M line array, providing an aesthetically pleasing alternative to ground stacked subs beneath the array. The iS118-M may also be flown along side the i212-M array as a bass array.

For applications where flown rigging is not possible, the iS118-M can serve as a ground stacking base for the i208-M line array speakers.

As with all Clair Brothers speaker products, the iS118-M is constructed with the finest Baltic birch plywood and finished with a rugged exterior black epoxy mastic finish to withstand the most demanding conditions.

OPTIONS & ACCESSORIES

iS118-i – Installation Model

Accessories: Ground Stack Rigging

Soft Cover and Dolly Transport

Custom Rigging

Custom Colors Available

iS118-M Subwoofer



AUDIO SPECIFICATIONS

Loudspeaker Type	Arrayable Subwoofer (Maximum Angle of 10° between cabinets)	
Frequency Response (+/- 2dB)	Single Cabinet -10 dB Point	34Hz-180Hz 30Hz
Recommended Power Amplifier	2400W @ 8 Ohms	
Sensitivity (1 Watt @ 1 Meter)	97 dB SPL	
Maximum Output	Cont. Peak	131 dB SPL 133 dB SPL
Driver	LF	(1) 18 in. (457.2mm)
Nominal Impedance	LF	8 Ohms
Power Handling	Nominal Peak	2000W 4000W
Input Connection	Standard	(2) EP-4 Connectors (1 Male, 1 Female)

MECHANICAL SPECIFICATIONS

Enclosure	Shell Finish	18mm Baltic Birch Black Epoxy Mastic
Grille	Perforated Steel with Tension Mechanism Foam Backed	
Dimensions	Front Height Rear Height Width Depth	20.24 in. (514.0mm) 15.49 in. (393.4mm) 28.87 in. (733.2mm) 30.39 in. (771.9mm)
Weight	144 lbs. (65.3kg)	
Shipping Weight	162 lbs. (73.5kg)	

Note: All wattage figures are calculated using the rated nominal impedance.
Clair Brothers products are designed to perform optimally by utilizing factory recommended proprietary DSP settings.

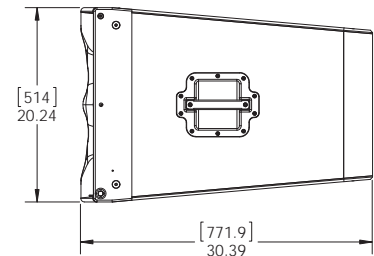
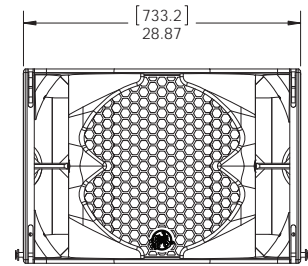
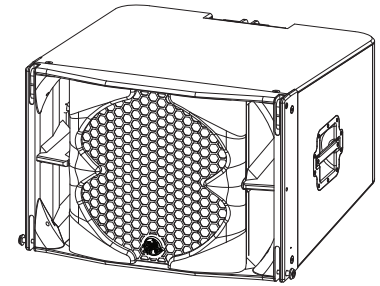

iS118-M EP-4 Pin Configuration

Pin	Use
1 & 3	Low (-)
2 & 4	Low (+)

ARCHITECT AND ENGINEER SPECIFICATIONS

The loudspeaker shall be a mobile subwoofer system containing (1) 18" driver in a vented enclosure. Power handling capacity shall be 2000 watts RMS nominal and 4000 watts RMS peak. The low frequency driver shall be 18" diameter capable of handling 2000 watts of pink noise with a 6 dB crest factor for 8 hours (as per EIA RS-426-A standard). The pass-band frequency range shall be at minimum, 34-180Hz with -10dB at 30Hz. The 18" transducer shall have a 5.3" (135mm) diameter dual-layer aluminum ribbon voice coil with a low-noise, forced ventilation magnet structure. The motor assembly shall have high thermal capacity and low thermal power compression characteristics. The enclosure shall be constructed of 18mm, 13-ply Baltic birch and be covered with a black epoxy mastic finish. The cabinet bracing shall be that of a gusset design providing uniform panel rigidity. The rigging system shall consist of i208/i212 compatible integrated rigging with provisions for both hanging and ground stacked applications. Dimensions shall be 20.24" high, 28.87" wide, and 30.39" deep. The system weight shall be 144 lbs (65.3kg). The loudspeaker system shall be the Clair Brothers iS118-M speaker.

CLAIR BROTHERS • ONE CLAIR BOULEVARD • MANHEIM, PA 17545 • 717-665-4000 • WWW.CLAIRBROTHERS.COM

CBAS20171019
Due to constant research, development and improvements all specifications are subject to change without notice.

